

Notice

This soap dispenser is suitable for normal, liquid soap cream for home use. Preferably use **mild, biodegradable and completely synthetic agents**, because they are generally more kind to the skin and the environment.

Attention: Especially industrial hand cleaners, natural (organic) liquid soaps and agents with a high content of disinfecting components can lead to faster wear of the pump cylinder.

The cleaning product must never contain abrasives and/or solvents.

If in doubt, consult the supplier of the cleaning product.

Global guidelines for liquid soaps, etc.:

pH	: 6 - 7	Complex images
Perfums	: < 1%	(EDTA, NTA)
Plant oils	: < 1%	Optimal
Animal fats	: < 1%	Viscosity (20°) : 700 -3000 mPa·s
		Seifomild soa p cream: 1500-2000 mPa·s

Some cleaning agents, such as natural soaps, contain substances that contaminate the pump cylinder when they dry out. To avoid the formation of soap residues etc., we recommend rinsing the pump cylinder regularly with hot water.

THANK YOU VERY
MUCH FOR CHOOSING
A SEIFOMAT® BUILT-IN
SOAP DISPENSER YOU
HAVE CHOSEN.

SEIFOMAT®
SEIFENSPENDER

Fritz Ostermann GmbH
Gottlieb-Daimler Str. 24
G-59439 Holzwickede
Phone +49 2301 91940-0
Fax +49 2301 91940-20
info@seifomat.de
www.seifomat.de



SEIFOMAT®
SEIFENSPENDER

To enjoy this product for a long time,
please observe the following instructions.

Filling the containers

Modell „Nova“, „de Luxe“, „Slim“ & „Air+Ship“ (Fig.1-2)

1. Loosen the pump cylinder by turning the upper part (A).
2. Pull out the pump cylinder by the push button.
3. Fill the container up to a maximum of half of the threaded shank fill (B).
4. After filling, screw the pump cylinder back in.

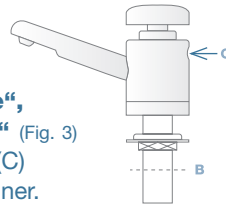
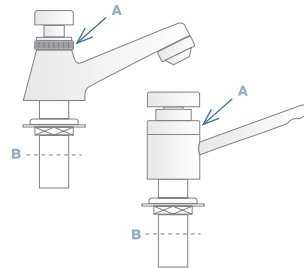

Modell „Safe“, „Exquisit“, „Square“, „Pure“, „Nova Steel“ & „Universal“ (Fig. 3)

1. Loosen the hexagon socket screw (C) with the loosen the hexagonal spanner.
2. Pull out the pump cylinder by the pull out.
3. Fill the container to a maximum of half fill the threaded shaft (B).
4. Replace the pump cylinder and keep it pressed.
5. Tighten the hexagon socket screw again and then release the pump cylinder.

Installation dimensions:

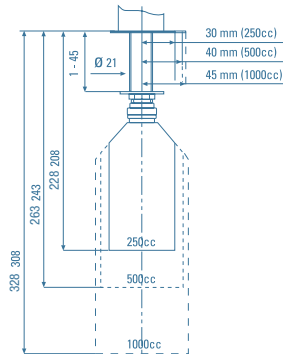

For filling we recommend our special funnel with venting ribs.

Maintenance and care

Never clean chrome-plated soap dispensers with aggressive cleaning agents containing acid or chlorine.

The pump cylinder can be completely dismantled for possible replacement of components:

- Dismantle the hose connector (pos. 15).
- Block the axle: Through one of the holes in the pump cylinder (s. arrow) a pin or something similar (\varnothing max. 3 mm) into the hole in the axle (pos. 09).
- Then unscrew the push button (pos. 01).
- The axle can now be removed from the pump cylinder.
- A revision kit is available.

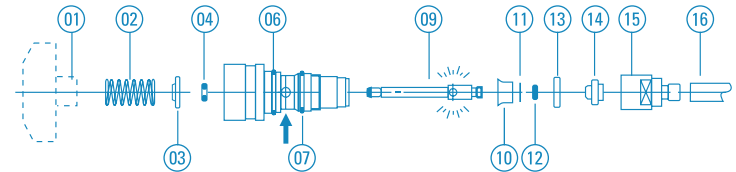

SPARE PARTS

14279957	Large revision set	(02,03,04,06,07,09,10,11,12,13,14,15,16)
14279981	Revision set Kiga	(02,03,04,06,07,09,10,11,12,13,14,15,16)
14279990	Revision set Steel	(02,03,04,06,07,09,10,11,12,13,14,15,16)
14279968	Small revision set	(03,04,06,07,10,11,12,13,14)*



Soap: We recommend our **soap cream Seifomild Zero**. This soap cream was specially developed for use in soap dispensers. It is discreetly scented with a pleasant fragrance, cosmetically mild to the skin, dermatologically tested, **free from environmentally harmful microplastic, chloride-free**, biodegradable and DIN-tested.

15999911	Soap for Seifomat soap dispenser	0,5 ltr. bottle	SC050
15999901	Soap for Seifomat soap dispenser	1,0 ltr. bottle	SC100
15999904	Soap for Seifomat soap dispenser	5,0 ltr. canister	SC500
15999907	Soap for Seifomat soap dispenser	10,0 ltr. canister	SC1000

* From production date 19-1 and older (see hose connector no. 15), do not install item 11 as the axle is too short